



## Installation Instructions Dual Decking System (Addendum)

Download the [latest version of the installation manual](#) and the [instructional video](#) at [www.govaplast.com](http://www.govaplast.com)

A close-up photograph showing the installation of the Dual Decking System. A thick, light-brown wooden board is being placed into a metal track. The track is mounted on a grey concrete surface. The metal track has a complex profile with a central channel and side rails. A black plastic component is visible at the end of the track.

A broad and  
sustainable vision  
| DUAL DECKING SYSTEM®

## INDEX

1. Mitre joint of support beams	3
2. Deck with <b>slanted side</b>	3
3. Deck with <b>slanted front</b>	5
4. Deck with <b>curved shapes</b>	6

These instructions are a supplement to the main installation guide and are specifically intended for the installation of decks with angled sides or curved designs. For the most recent version, please refer to our website.

<https://www.govaplast.com/downloads-usermanual-en>

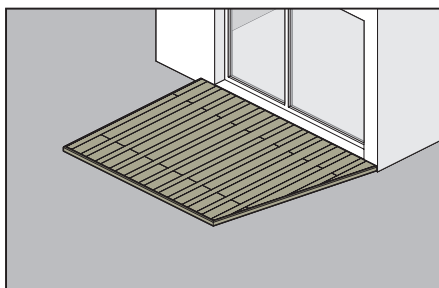

deck with slanted side

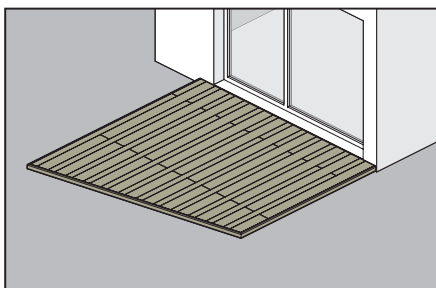

deck with slanted front

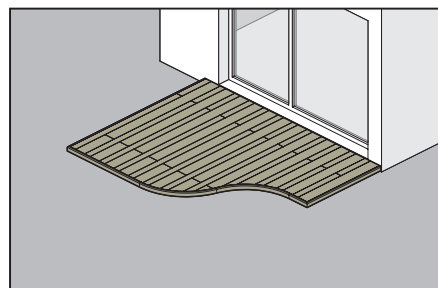

deck with curved shapes

## 1. Mitre joint of support beams

The connection plate allows for angles up to a maximum of 45°.

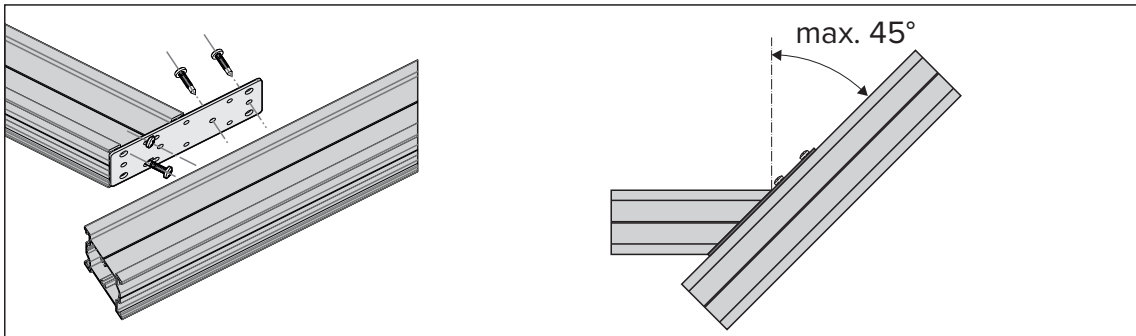

## 2. Deck with slanted side

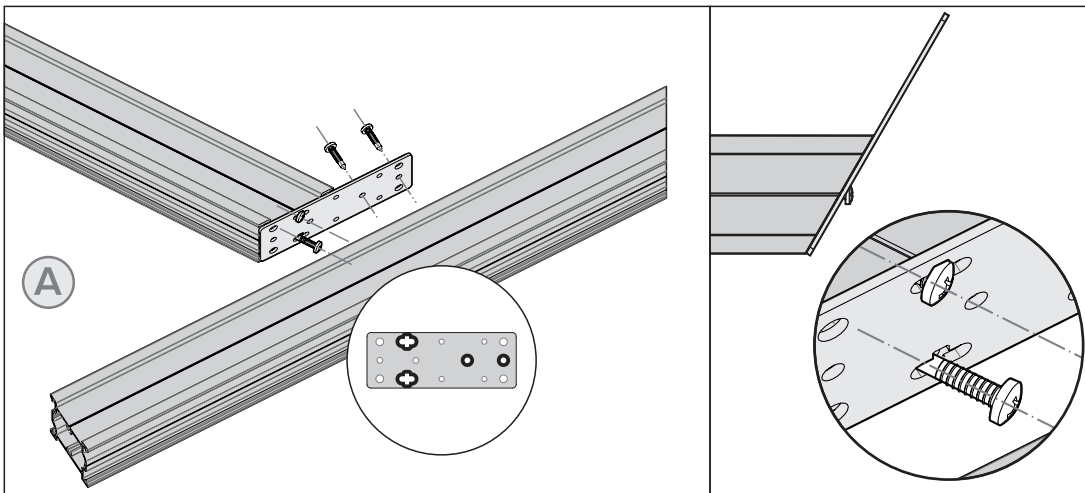

Use the cross-shaped holes to attach the connection plate to the bevelled end of the profile.

Board installation for a deck with an slanted side.

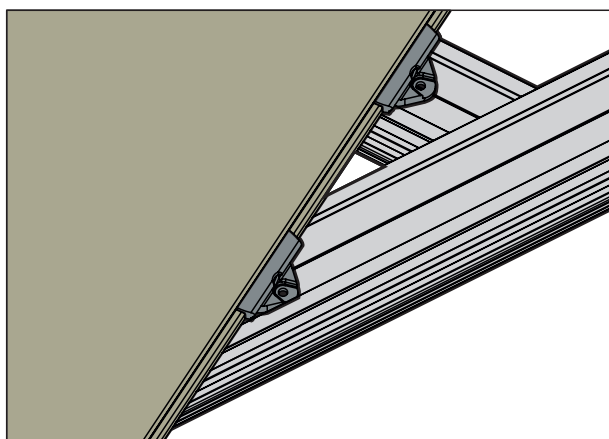
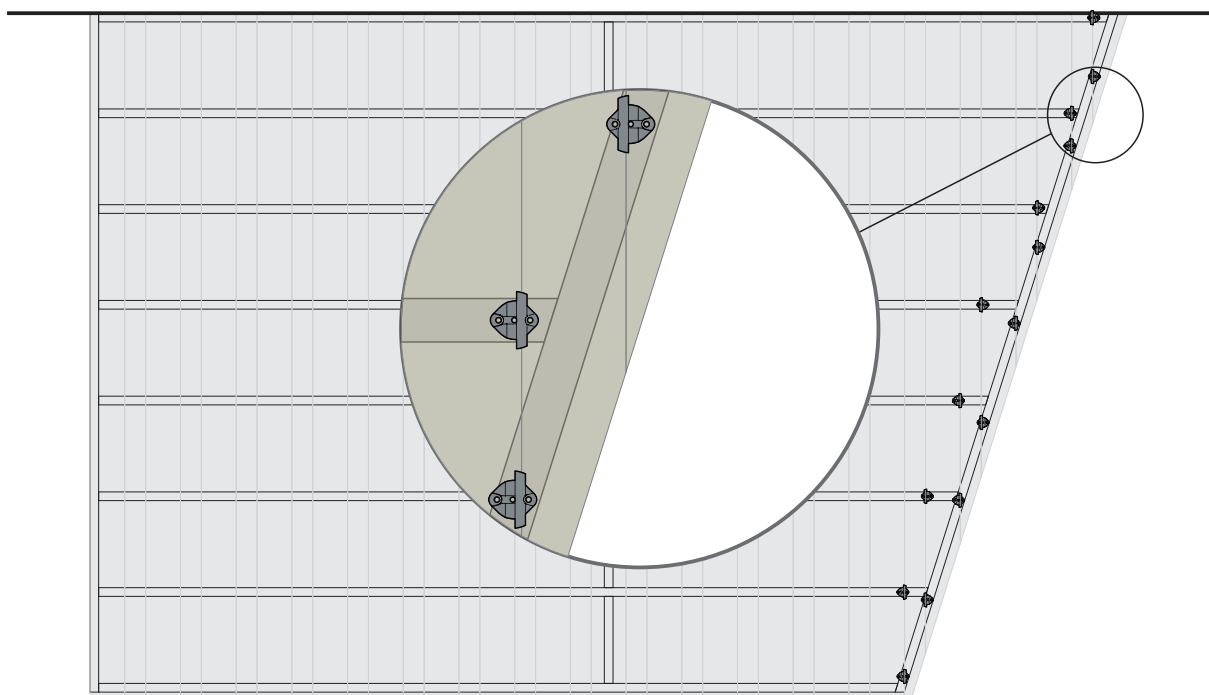

If the mid-connects need to be rotated more than 45°, mark their position, then remove a portion of the profile edge using a grinder and pliers.

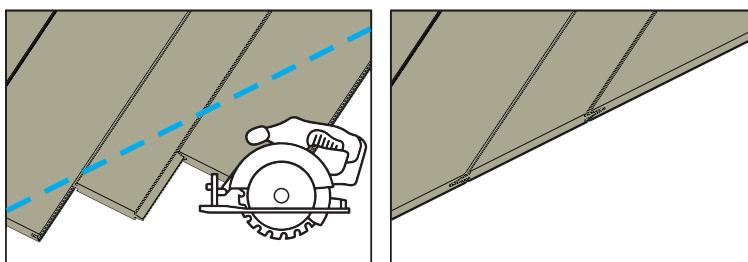
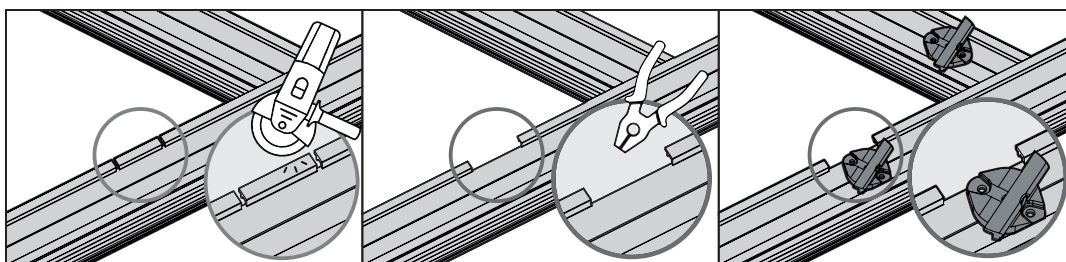

Once all boards are installed, cut them in one pass for a clean, straight edge.

### 3. Deck with slanted front

Use the cross-shaped holes to attach the connection plate to the bevelled end of the profile.

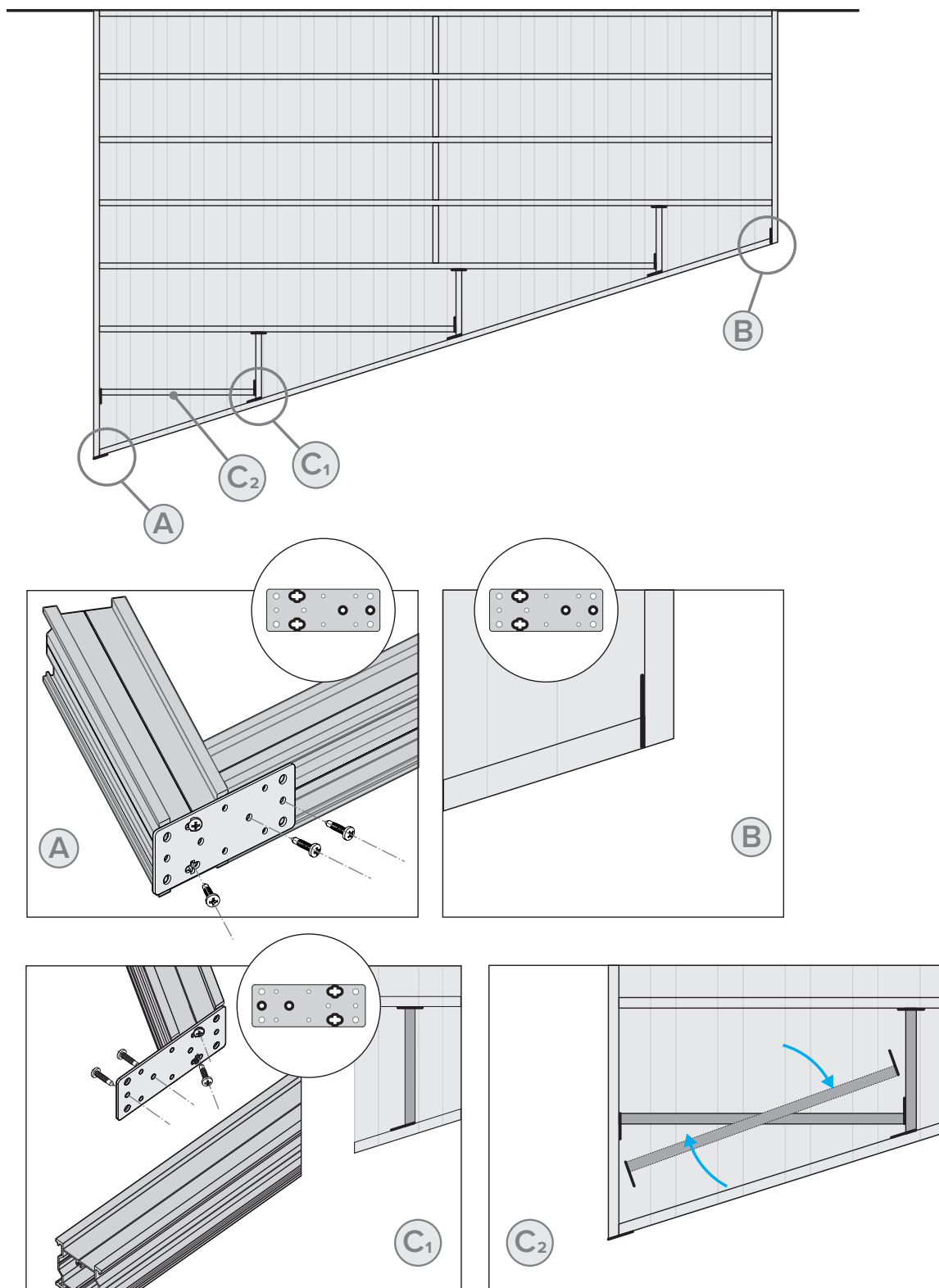

#### 4. Deck with curved shapes

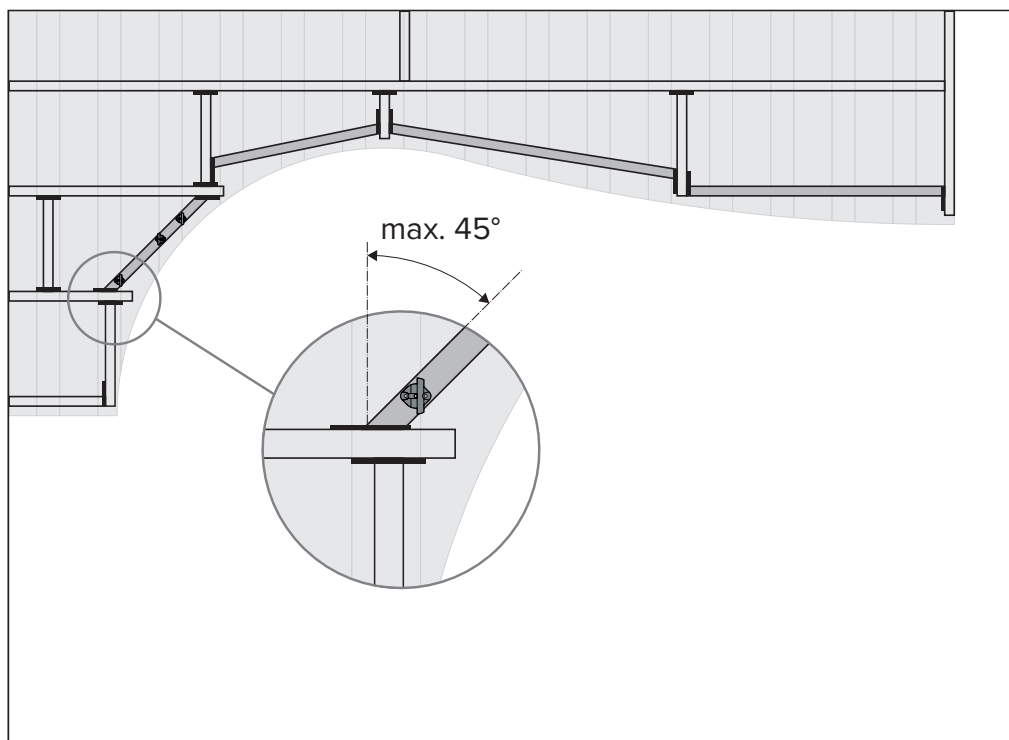
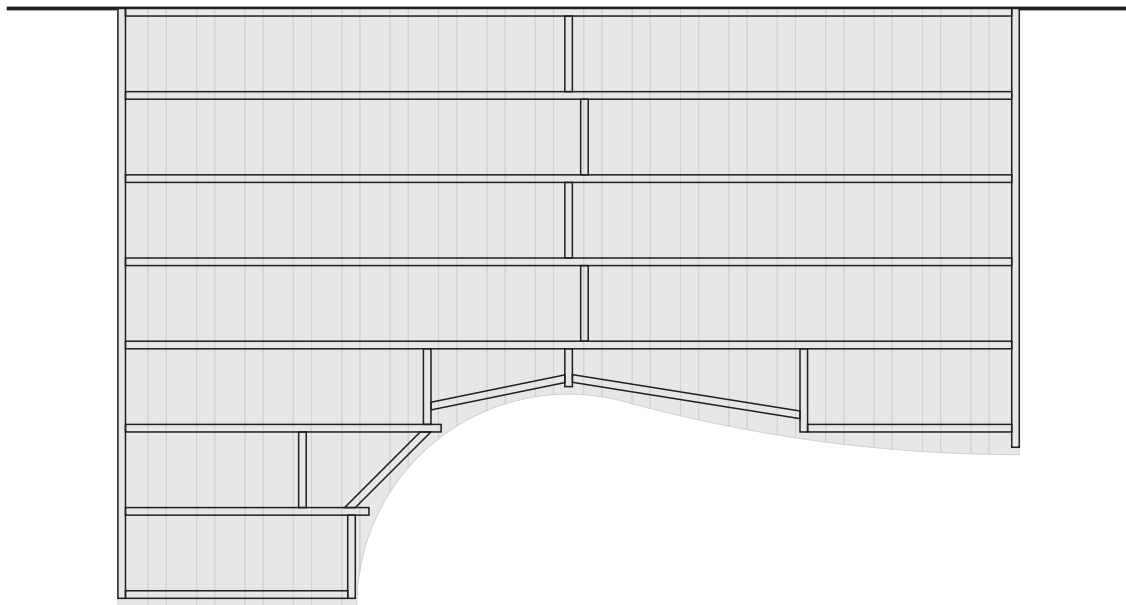

When constructing a substructure with curved shapes, keep in mind that the connection plate allows for a maximum angle of 45° (see page 3).